

leurope.jacobs.com/loc4/MFS/Projects/Highways/Projects/BRJ10612 - Middlewich Eastern Bypass/BRJ10612-4.2 Trent & Mersey Canal Bridge/Detailed Design/SSBSO drawings/BRJ10612-S-BSO-003.dwg - 13/08/2021 10:01:00 - A1Frame - Adebyf

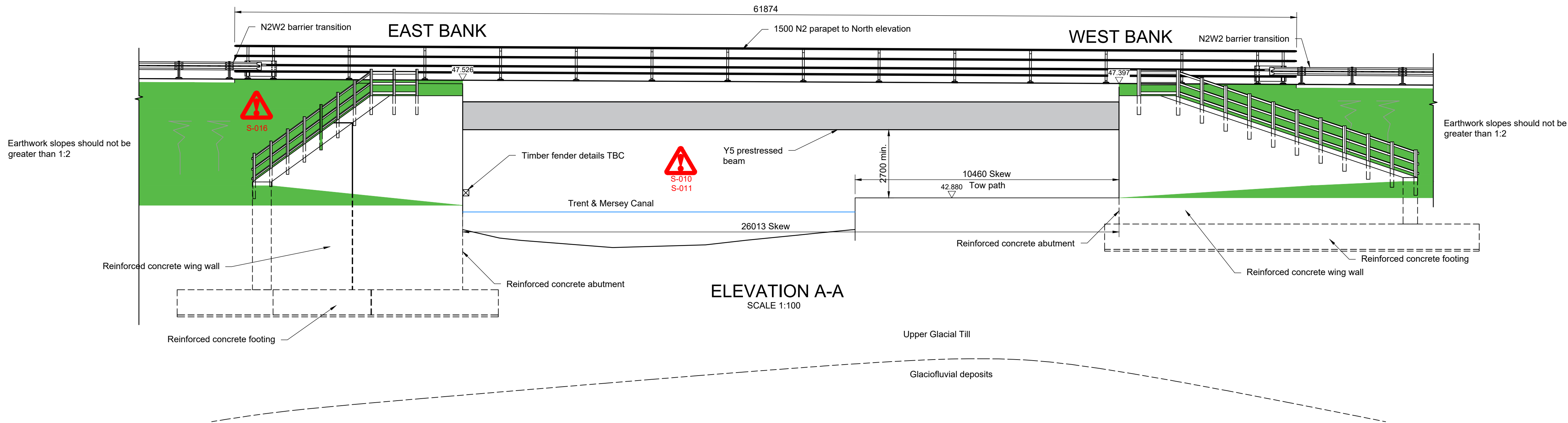

ELEVATION A-A
SCALE 1:100

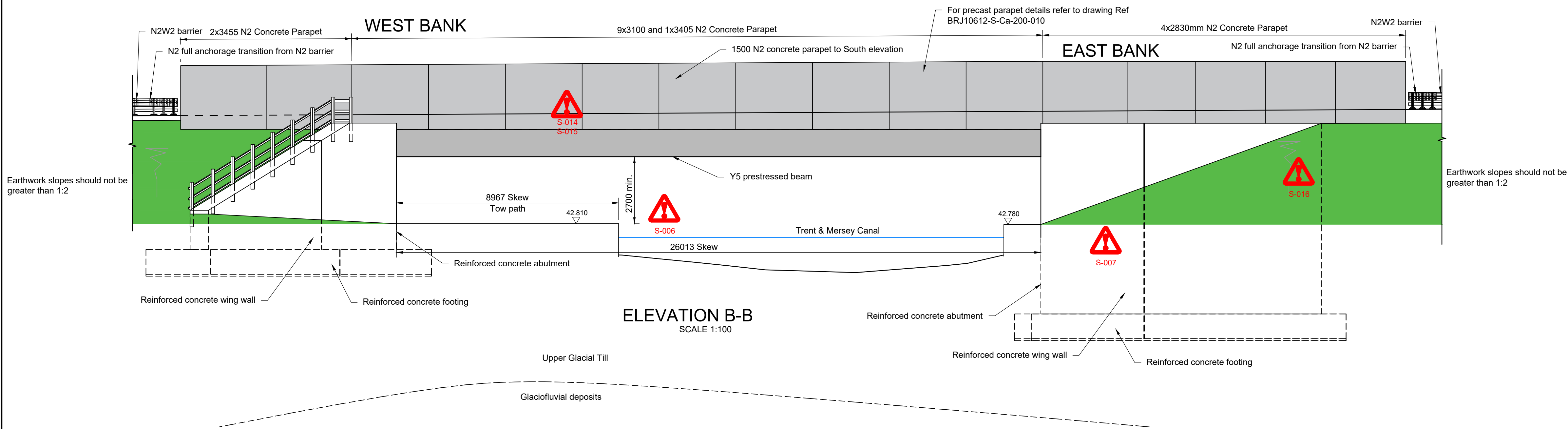

ELEVATION B-B
SCALE 1:100

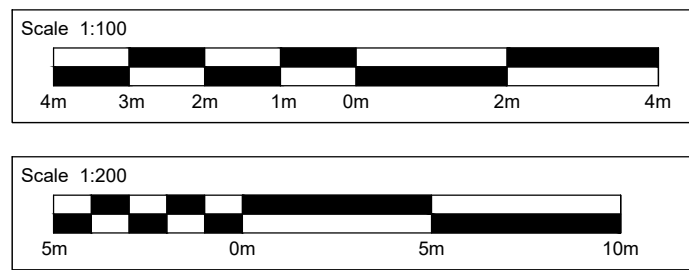

Notes:

1. Drawing based upon BRJ10612-S-Ca-200-003 rev T03.
2. This drawing is to be read in conjunction with all other drawings in this series. Refer to Drawing No. BRJ10612-S-Ca-200-001 for drawing list and general notes.
3. All dimensions are given in millimeters unless noted otherwise
4. All levels (above Ordnance Datum Level) and chainages are given in metres.
5. 25x25 chamfer to all exposed arises unless noted otherwise
6. Kerb type changes from H2 half battered to combined kerb and drainage system along the South verge. Refer to drawing BRJ10612-H-1100-109 for details.

The Common Seal of
CHESHIRE EAST BOROUGH COUNCIL
was hereunto affixed
in the presence of

Dated this day of 2021



SAFETY, HEALTH AND
ENVIRONMENTAL INFORMATION

In addition to the hazards/risks normally associated with the types of work detailed on this drawing, note the following:

CONSTRUCTION

- S-006 - Working near water.
- S-007 - Lyme's disease from activities around water and vegetation.
- S-008 - Water ingress in foundation pit.
- S-009 - Settlement of substructure.
- S-010 - Working in proximity to construction/waterbourne traffic.
- S-011 - Working in proximity to the live navigable canal.
- S-012 - Unknown buried statutory apparatus.
- S-013 - Collapse of excavated face and/or temporary slope.
- S-014 - Lifting and handling of precast concrete units.
- S-015 - Instability of precast units upon lay down.

MAINTENANCE / CLEANING

- S-016 - Slips, trips and falls due to uneven ground conditions.

DECOMMISSIONING / DEMOLITION

- As above

It is assumed that all works will be carried out by a competent contractor working, where appropriate, to an approved method statement

T00	12/08/21	For Bridging Scheme Order	FA	JD	MH	PH
Rev	Rev. Date	Purpose of revision	Drawn	Checked	Rev'd	Appr'd

Jacobs

5 First Street, Manchester, M15 4GU
Tel: +44 (0) 161 235 6000 Fax: +44(0)161 235 6001
www.jacobs.com

Client



Project

THE CHESHIRE EAST COUNCIL
(MIDDLEWICH EASTERN BYPASS - TRENT AND
MERSEY CANAL BRIDGE) SCHEME 2021

Drawing title

TRENT & MERSEY
CANAL BRIDGE
GENERAL ARRANGEMENT
ELEVATIONS

Drawing status

FOR BRIDGING SCHEME ORDER

Scale	AS SHOWN @ A1	DO NOT SCALE
Jacobs No.	BRJ10612	
Client no.	N/A	

Drawing number	BRJ10612-S-BSO-003	Rev	0
----------------	--------------------	-----	---

© Copyright 2020 Jacobs U.K. Limited. The concepts and information contained in this document are the property of Jacobs. Use or copying of this document in whole or in part without the written permission of Jacobs constitutes an infringement of copyright. Limitation: This drawing has been prepared on behalf of, and for the exclusive use of, Jacobs' Client, and is subject to, and issued in accordance with, the provisions of the contract between Jacobs and the Client. Jacobs accepts no liability or responsibility whatsoever for, or in respect of, any use of, or reliance upon, this drawing by any third party.